

### 35.Keyless Access CM

#### A: REMOVAL

- 1) Remove the cover assembly - instrument panel LWR driver and the knee airbag module. <Ref. to AB-34, REMOVAL, Knee Airbag Module.>
- 2) Release the lock and remove the fuse holder.

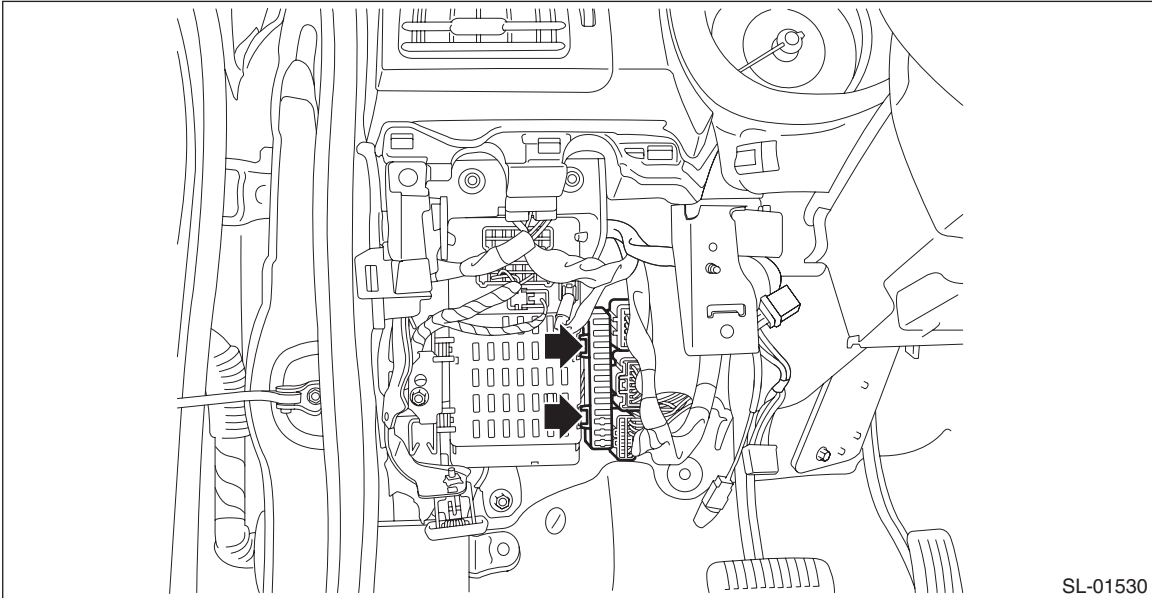

- 3) Remove the relay & fuse box.
  - (1) Disconnect the connector.
  - (2) Remove the bolts and nuts, and remove the relay & fuse box.

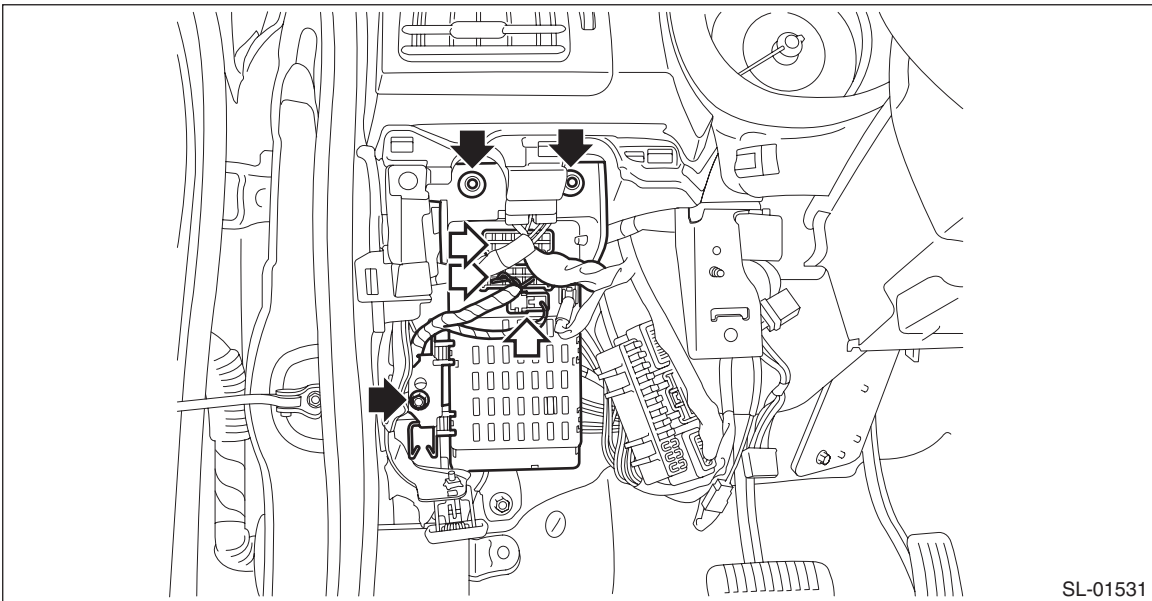

4) Remove the keyless access CM.

**CAUTION:**

**Be careful to keep water and other foreign materials away from body integrated unit.**

(1) Disconnect the connector.

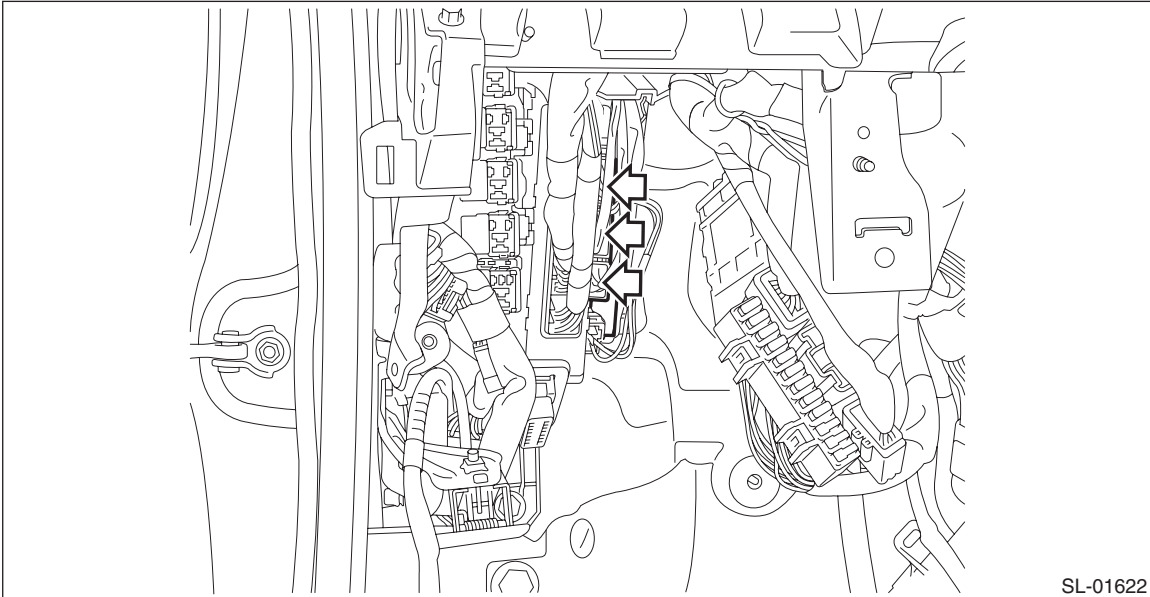

SL-01622

(2) Release the claws, and pull out the keyless access CM from the bracket.

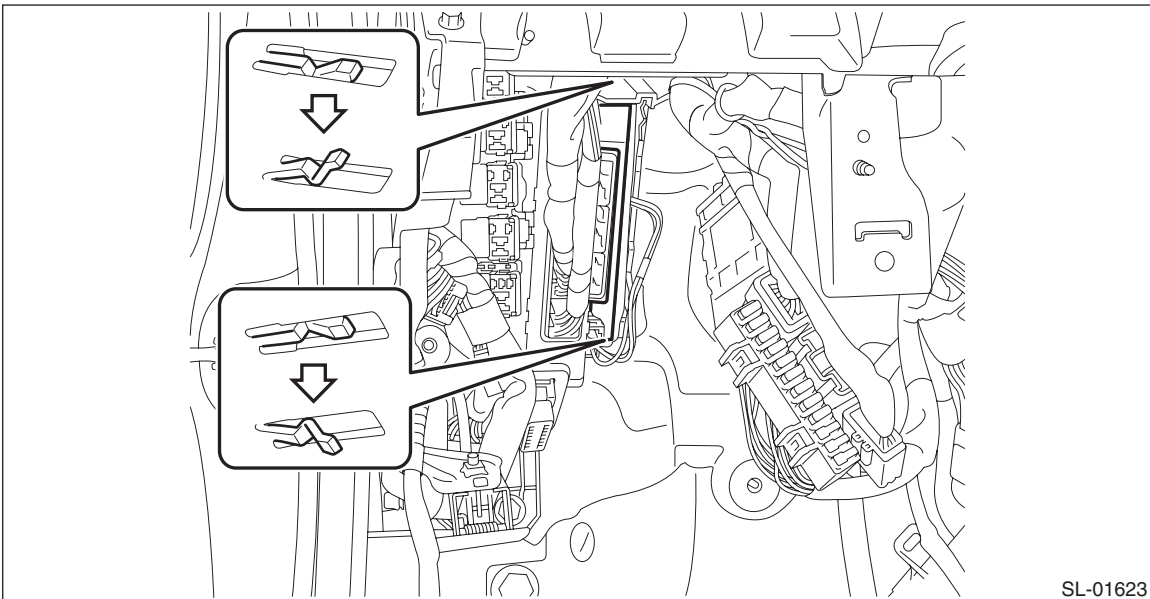

SL-01623

## B: INSTALLATION

**CAUTION:**

**Registration of the immobilizer is necessary when a immobilizer-related control module has been replaced. For detailed operation procedure, refer to the “REGISTRATION MANUAL FOR IMMOBILIZER”.**

Install each part in the reverse order of removal.

**Tightening torque:**

**Relay & fuse box: 7.5 N·m (0.76 kgf·m, 5.5 ft·lb)**